

# Pipeline Ancillaries

## Separators AS 2

Combined Valve with integrated Trap



### Technical Data

Connection DN	15 - 50
Connection G	1/2 - 2
Nominal Pressure PN	16
Operating Pressure	0 - 13 bar
Collection Efficiency	max. 1200 l/h
Temperature	190 °C
Medium	gases and steam

### Description

Centrifugal separators use the cyclone principle to separate automatically liquids, solids and steam from gas flows while the gas is under operating pressure. The liquid trap built into the separator body operates instantaneously and its operation is not impaired by backpressure or pressure fluctuations. The collected liquid is safely drained by the float control. No additional energy input is required.

Separators type AS 2 are of inline design and have their drain outlets at the bottom. For a nominal width of DN 15 - 25 and G 1/2 - 1, the outlet is arranged at the bottom, and for a nominal width of DN 40 - 50 and G 1 1/2 - 2, it is arranged laterally. Being entirely constructed of corrosion-resistant stainless steel, they can be used universally, i.e. especially for corrosive media.

The optimised flow geometry allows a separation performance of 99 %. The maximum separation capacity is achieved at a flow velocity of 25 – 30 m/s. The flow velocity should not exceed 35 m/s.

Top and bottom sections of the valve body are connected by a clamp ring and two bolts. Servicing/maintenance is easy and does not call for special tooling.

### Standard

- » All stainless steel construction (CrNiMo steel)
- » Quick-release body clamp ring
- » Built-in liquid trap

### Options

- » Various seal materials to suit your medium
- » Expansion pipe connection in body top section for separating liquids from compressed air or gases
- » Other connections on request
- » Special designs on request

### Product features in brief

- » Optimised flow geometry, 99 % separation performance
- » Inline design with drain outlet at the bottom
- » Built in steam trap
- » Compact and lightweight thanks to deep-drawn components
- » Corrosion-resistant CrNiMo steel
- » Various connection options

Please state working pressure range when enquiring or ordering.

Operating instructions, know how and safety instructions must be observed. The pressure has always been indicated as overpressure. We reserve the right to alter technical specifications without notice.



### Collection Efficiency [l/h] and Pressure Ranges [bar]

Δp bar	G 1/2 - 1, DN 15 - 25 pressure range bar			G 1 1/2 - 2, DN 40 - 50 pressure range bar
	0 - 2	0 - 6	0 - 12	0 - 13
0,1	70	19	6	220
0,2	100	28	9	320
0,5	160	40	12	710
1	230	70	18	980
2	350	110	27	1200
4	-	160	46	1200
6	-	200	50	1200
8	-	-	60	1200
10	-	-	70	1180
12	-	-	75	1030
13	-	-	-	950

### max. Flow Rate

medium	nominal diameter	
	G 1/2 - 1, DN 15 - 25	G 1 1/2 - 2, DN 40 - 50
gases	400 Nm <sup>3</sup> /h	1000 Nm <sup>3</sup> /h
steam	175 kg/h	400 kg/h

# Pipeline Ancillaries

## Separators AS 2

Combined Valve with integrated Trap



Materials		
Nominal Diameter	G 1/2 - 1, DN 15 - 25	G 1 1/2 - 2, DN 40 - 50
Body	CrNiMo-steel	CrNiMo-steel
Body Seal	EPDM optional FEPM	EPDM optional FEPM
Seat, Cone	CrNiMo-steel	CrNiMo-steel
Float	CrNiMo-steel	CrNiMo-steel
Valve Seal	FFKM	CrNiMo-steel

Dimensions Sleeve Connection [mm]				
size	nominal diameter			
	G 1/2	G 1	G 1 1/2	G 2
A*	165	155	195	on request
AE*	-	-	238	on request
B	221	225	330	330
D	140	140	200	200
E	G 1/2A	G 1/2A	G 3/4A	G 3/4A

Dimensions Flange Connection [mm]				
size	nominal diameter			
	DN 15	DN 25	DN 40	DN 50
A*	on request	195	240	295
AE	-	-	260	288
B	225	225	330	330
D	140	140	200	200
E	G 1/2A	G 1/2A	G 3/4A	G 3/4A

\* Overall length tolerances in acc. with DIN EN 558

Weights Sleeve Connection [kg]				
nominal diameter				
G 1/2	G 1	G 1 1/2	G 2	
2,6	2,6	3,5	on request	

Weights Flange Connection [kg]				
nominal diameter				
DN 15	DN 25	DN 40	DN 50	
on request	5	10	11,5	

**Customs Tariff Number**  
84818099

Special designs on request.  
The pressure has always been indicated as overpressure.  
Mankenberg reserves the right to alter or improve the designs or specifications of the products described herein without notice.

### Dimensional Drawing

G 1, DN 25

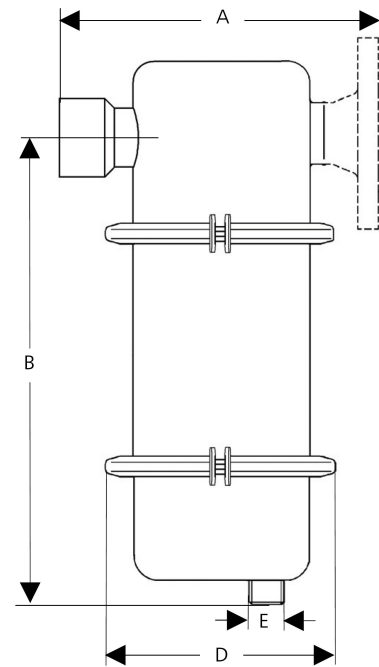

G 1 1/2, DN 40

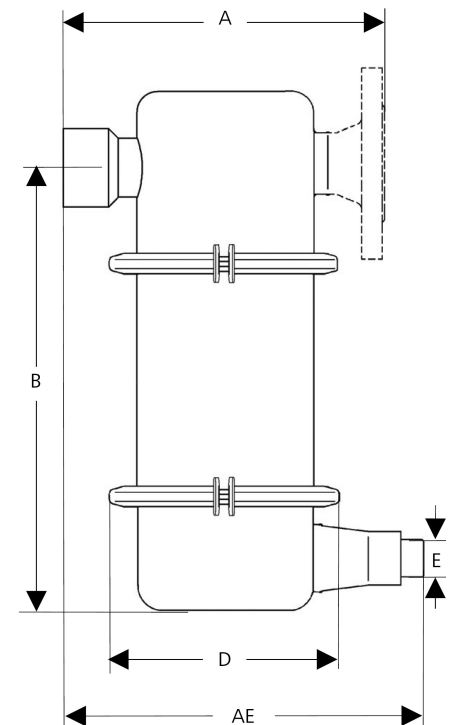

Authorised Distributor:



46, Jalan SS 22/21, Damansara Jaya,  
47400 Petaling Jaya,  
Selangor Darul Ehsan, Malaysia.

Email: [nog@nog.com.my](mailto:nog@nog.com.my)  
Webste: [www.nog.com.my](http://www.nog.com.my)